

FLOOR PLAN

Tim Curry Criminal Justice Center - 5th Floor

SCALE: 3/16"=1'-0"

KEYED NOTES

1. REMOVE EXISTING DOOR, FRAME AND CARD READER AND DEMO ADJACENT WALL. RELOCATE DOOR, FRAME AND CARD READER TO NEW LOCATION AS SHOWN. PATCH AND REPAIR WALL AND CEILING WHERE WALL WAS REMOVED. PAINT WALL TO MATCH EXISTING.
2. REMOVE EXISTING DOOR AND FRAME AND CLOSE OPENING TO MATCH EXISTING WALL METAL STUD STRUCTURE AND WALL FINISHES. SALVAGE AND RELOCATE EXISTING DOOR(S) ONLY.
3. CUT OPENING IN EXISTING WALL FOR RELOCATED 3'-0" x 7'-0" DOOR WITH NEW H.M. FRAME TO MATCH EXISTING FINISH. PROVIDE NEW FLOORING TO TO MATCH EXISTING.
4. REMOVE AND RELOCATE EXISTING CEILING MOUNTED "EXIT" SIGN. REPLACE/REPAIR CEILING TILE.
5. PROVIDE NEW GYP. BD. ON MTL. STUDS WALL TO 12" (1'-0") ABOVE EXISTING CEILING WITH RELOCATED DOOR, CARD READER AND NEW DOOR FRAME. SEE SECTION AS NOTED. Note: CONSTRUCT NEW WALL AFTER DOOR #1 HAS BEEN REMOVED AND OPENING HAS BEEN CLOSED.
6. INSTALL CEILING MOUNTED "EXIT" SIGN, ADJUST CEILING TILE AS NEEDED.

2

WALL SECTION

Note: CONSTRUCT NEW WALL AFTER DOOR #1 HAS BEEN REMOVED AND OPENING HAS BEEN CLOSED. SCALE: 1/2"=1'-0"

1

INTERIOR ELEVATION

SCALE: 3/8"=1'-0"

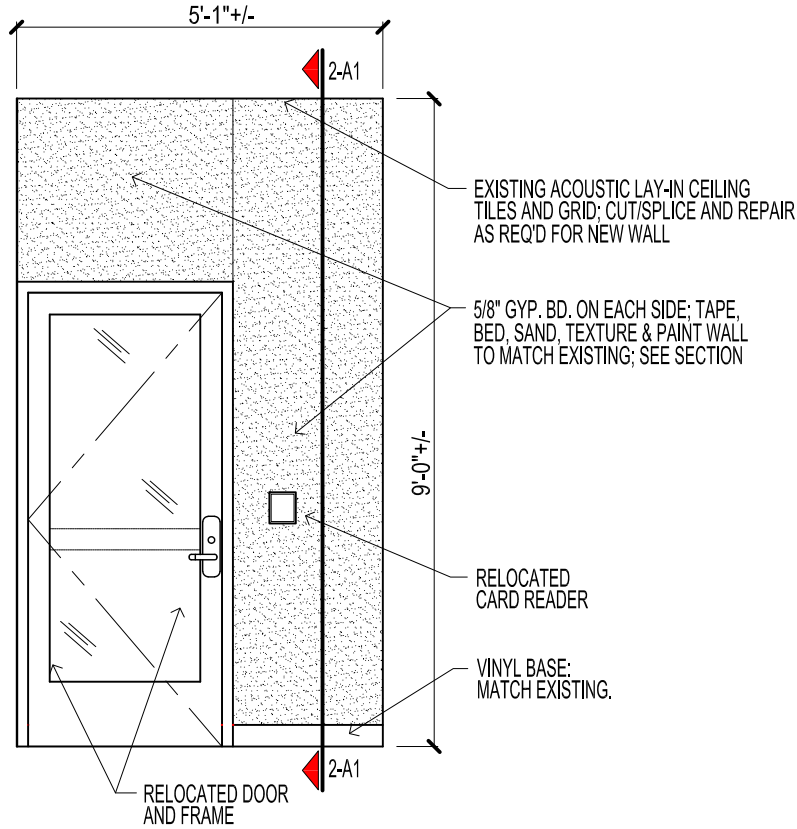
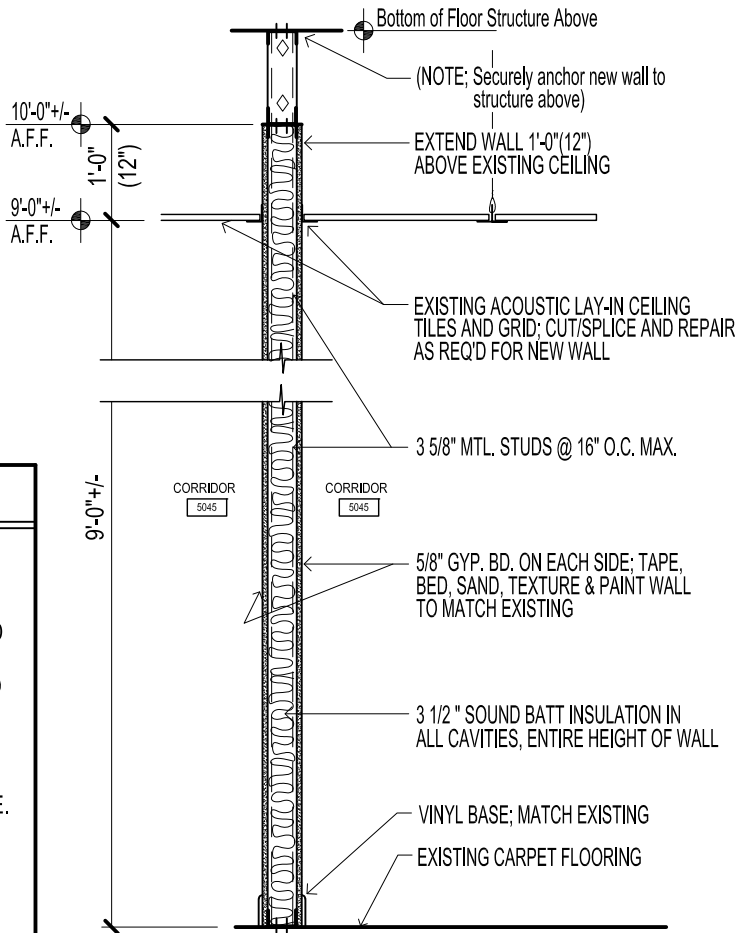

Project Location

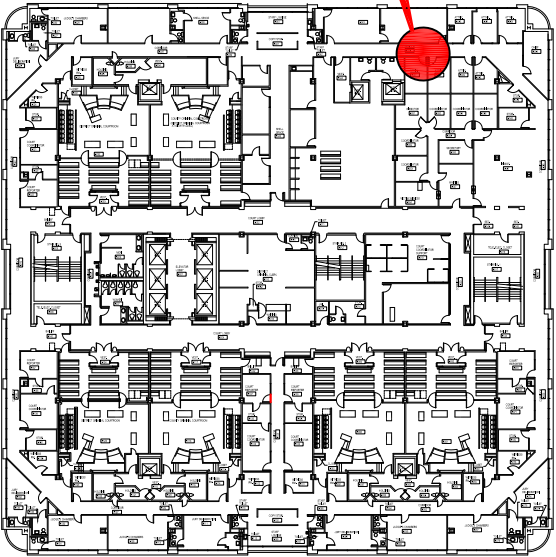

Tim Curry Criminal Justice Center - 5th Floor
401 West Belnap Street Fort Worth, Texas 76196

PROJECT LOCATION

N.T.S.



Tarrant County - Facilities Management
Construction Services
100 W. Weatherford St. Room 350
Fort Worth, Texas 76196
p: (817) 894-1502

TIM CURRY CRIMINAL JUSTICE CENTER
5TH FLOOR NORTH CORRIDOR SECURE DOOR MOVE
401 WEST BELNAP STREET
FLOOR PLAN, ELEVATION, WALL SECTION, KEYED NOTES, LOCATION PLAN

DRAWING NUMBER
TCCJC 5th Fl. Security Door Relocate
DATE: January 12, 2023
DRAWN BY: H.C.
SHEET NO.
A-1
1 OF 1 SHEETS